

KENDRICK OBSERVATORY TENT

READ THESE INSTRUCTIONS CAREFULLY BEFORE ATTEMPTING ASSEMBLY.

STEP 1: Find an area that is reasonably level and free of sharp objects.

STEP 2: Unroll your tent with floor side down. Stretch out tent so that it is flat and edges appear straight. Starting at one front corner, attach to the ground with a peg. Go to the other front corner, pull until the edge is straight (but do not overstretch) and peg it to the ground. Go to a back corner and pull until tent is square and edges are straight. Peg it to the ground. Go to the last corner and pull it until edges are straight and tent appears square. Peg it to the ground. Now peg all the remaining loops to the ground.

STEP 3: Unzip the doors of the tent to allow air to get in for easier assembly.

STEP 4: Assemble all three pole sets by inserting the pole segments into one another.

(See Fig. 1.)

Lay out the three assembled poles. The longest pole (222") is for the centre sleeve. The shortest pole (201") is for the right side of the tent as you face the doorway of the main tent (or over the side window). The last pole (213.5") is for the left side of the tent.

Now insert the poles through the sleeves.

Make sure when inserting poles not to catch the edges of sleeves.

STEP 5: Take the fly and position it over the tent with the doors of the fly aligned with the doors on the tent. The tie tapes should be on the underside of the fly. Now flip the fly partially back so you can attach the fly with the tie tapes to the loops on the centre of the tent and to the poles. (This step is easier to do before the tent is erected)

STEP 6: With your assistant at the opposite side of the tent, raise centre pole and insert metal ferrules of pole into the pins on either side at the bottom. (See Fig. 3)

Repeat the same with the two side sleeves. (See Fig. 4)

Secure the tent to the poles by snapping the clips to the poles front and back (See Fig. 5) and make any necessary adjustments. At the back of the fly inside seams there are tie tapes. Make sure you make a knot by going around the poles. This will secure the position of the fly. Now peg down, diagonally of the tent corners the four corner loops of the fly. (See Fig. 6)

STEP 7: Take the fly and stake it down by the loops. **NOTE:** When using the tent as an Observatory, roll the fly back to the centre pole of the tent and secure to the centre pole with the tie tapes.

Your tent is now completely set up. Have a great time!

Do's & Don't's

Inspect your tent upon receipt.

Do not pack up wet. If you must pack up wet be sure to unpack and dry thoroughly as soon as you get home.

Do not use in winds in excess of 40 mph (65 kph).

Do not stress the tent fabric when putting up the tent. It is possible to tear the fabric.

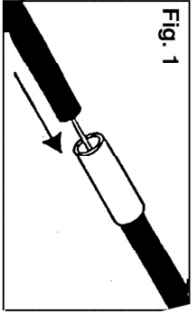

Fig. 1

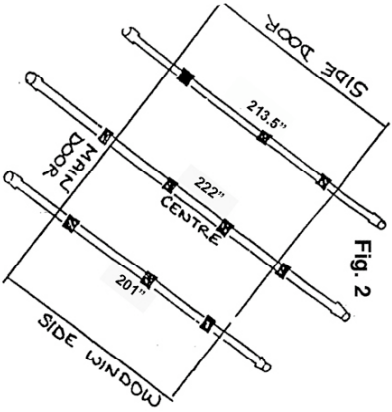

Fig. 2

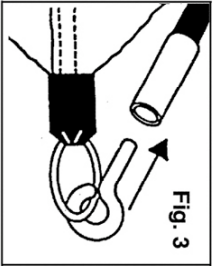

Fig. 3

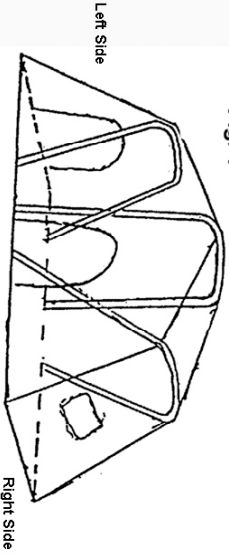

Fig. 4



Fig. 5

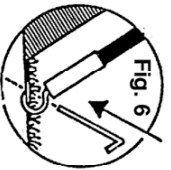

Fig. 6

Left Side

Right Side